

Copyright © 2010, Alarm Design Solutions Inc. All plans, specifications & other documents prepared by the architect/engineer are subject to copyright protection under "Architectural Work" under Section 101 & 102 of the Copyright Act, 17 U.S.C., amended December, 1996, and shall remain the property of the Architect. The Architect shall retain all common law, statutory and other reserved rights, including the copyright, therein. The protection includes but is not limited to the overall form as well as the arrangement and composition of spaces and elements of the design. Under such protection, unauthorized use of these plans, work or forms represented, can legally result in the cessation of such construction or building being stated on/for record.

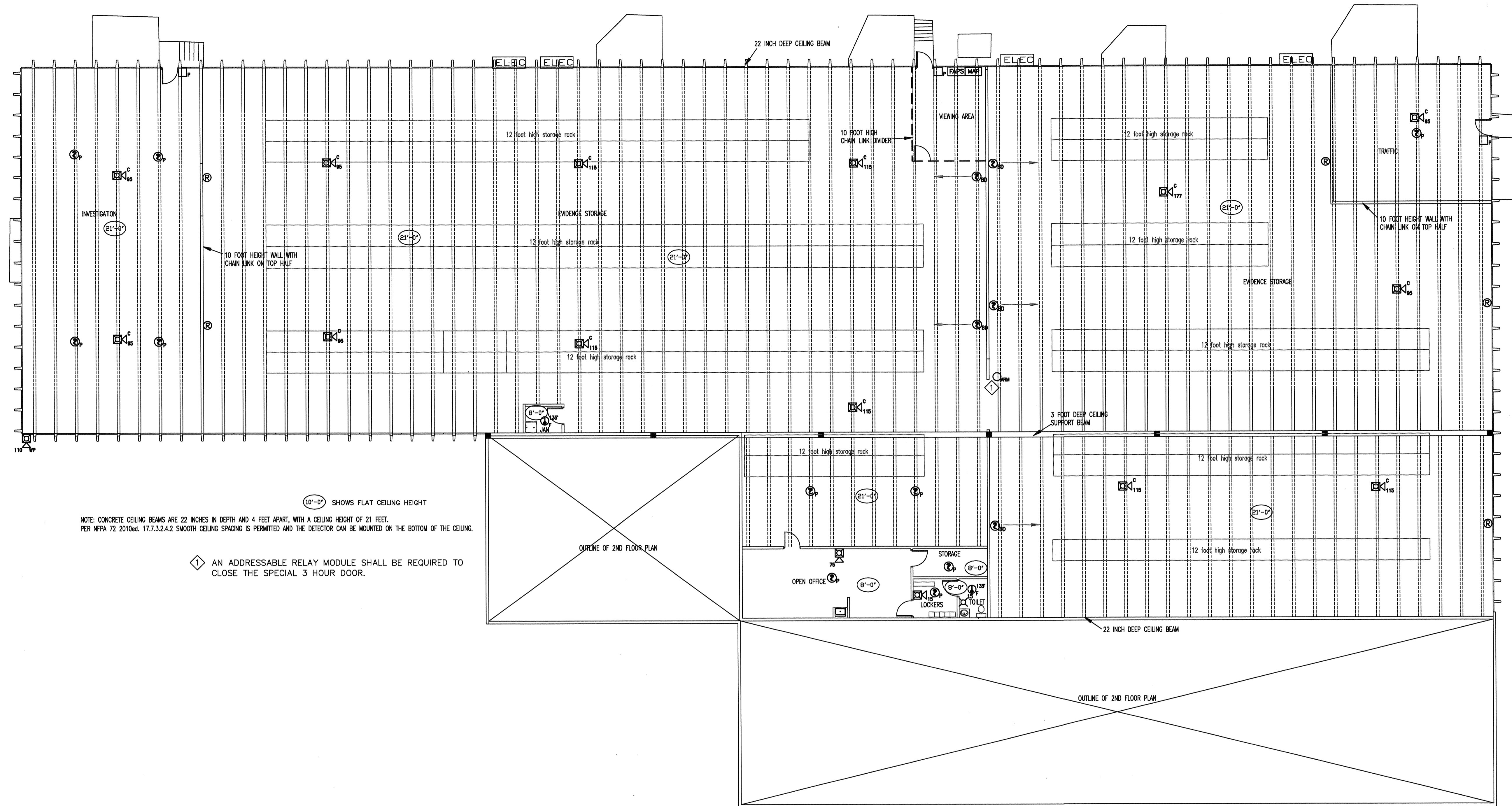

SYMBOL	DESCRIPTION
	FIRE ALARM CONTROL PANEL
	FIRE SYSTEM MAP
	SMOKE DETECTOR (PHOTOELECTRIC)
	BEAM DETECTOR
	BEAM DETECTOR REFLECTOR
	HEAT DETECTOR 135° FIXED TEMP
	PULL STATION
	STROBE (NUMBER INDICATES CANDELA)
	HORN WITH STROBE (NUMBER INDICATES CANDELA)
	C INDICATES CEILING MOUNTED
	ADDRESSABLE RELAY MODULE
	LEGEND

Fire Alarm System Notes:

1. Fire alarm control panel shall be addressable and have the capacity for the future office space finish of second floor.
2. Fire alarm contractor is responsible to prepare a full fire alarm submittal to obtain an installation permit from West Metro Fire.
3. The building shall remain non sprinkled.
4. The fire alarm devices shown are for bidding purposes. It is the responsibility of the installing contractor to meet West Metro Fire's requirements.
5. West Metro Fire is currently following NFPA 72 2010ed and amendments to IFC 2006ed.
6. There are not any air handling units that require duct detection.
7. There are some exhaust ducts that might interfere with the beam detectors line of site. This might require additional devices.

FIRE ALARM FLOOR PLAN

SCALE: 3/32" = 1'-0"



FIRE ALARM LAYOUT BY:

Alarm Design Solutions Inc.
 8391 Delaware St, Suite 103
 Denver, CO 80221
 (303) 828-0802
 Fax (303) 828-4381

CAI DESIGN GROUP INC.
 ARCHITECTS / ENGINEERS / CONSTRUCTION MANAGEMENT
 1440 10th Street - Suite A - Aurora, CO 80010
 PHONE: 303-941-1421
 E-MAIL: chidreign@comcast.net
 FAX: 303-968-1775

870 PARFET
 CITY OF LAKEWOOD
 870 PARFET STREET
 LAKEWOOD, COLORADO 80215
 CITY OF LAKEWOOD

Issue Record:
 CD SET 02/15/10

Designed By: _____ Drawn By: _____

Date: 01/28/10 Approved By: _____

Project No.: _____ File Name: _____

Sheet Title:
 FIRE PROTECTION
 PLAN

Sheet Number:
 FP101
 SHEET of _____